

"A" Heights	"B"	Post	Wall
36 inch		2 1/2" Sq. Tube x 0.080"	
42 inch		2 1/2" Sq. Tube x 0.125"	
48 inch		3" Sq. Tube x 0.125"	
54 inch		4" Sq. Tube x 0.125"	
60 inch			

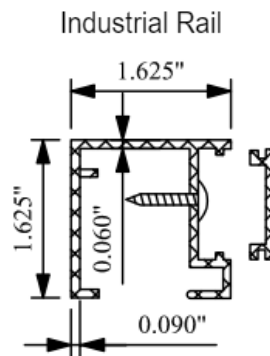

NOTES:

1. INSTALLATION TO BE COMPLETED IN ACCORDANCE WITH MANUFACTURERS SPEC.
2. DO NOT SCALE DRAWINGS
3. SPECIFICATIONS SHOWN CAN BE CHANGED ONLY BY THE MANUFACTURER.
4. FOOTING WIDTH: (4) X POST WIDTH
FOOTING DEPTH : MIN. 24"/REC. FREEZE LINE
5. PANELS SHOWN WITH MORTISED POST SYSTEMS.
6. PANELS ARE RACKABLE WHICH MAY CHANGE FACE-TO-FACE DIMENSION

MAVERICK ULTRA II™ INDUSTRIAL

Panel width 8' Barcelona Tradition Bottom 2 Rail Standard